

Actual view from the project



## THE GODREJ LEGACY, IN ALL ITS GOODNESS

The Godrej story began in 1897, with the manufacturing of locks. Since then, we have set several benchmarks. From a state-of-the-art manufacturing facility in a suburb of Mumbai, we've reached homes, offices, industries and the hearts of millions of people in India and around the world. With a proud tradition of many firsts, we find ourselves at work every day, building on the foundation of trust that was laid 125 years ago.



Actual photograph of Godrej One, Mumbai





## OUR SUCCESS OVER THE YEARS

In recent years, Godrej Properties has received over 250 awards and recognitions

Builder of the Year CNBC -  
Awaaz Real Estate Awards 2019

Real Estate Company of the Year -  
8<sup>th</sup> Annual Construction Week India Awards 2018

Brand Trust Report The Most Trusted  
Real Estate Brand in 2019

India's Top Builders 2018'  
Construction World Architect and Builder (CWAB)  
Awards 2018

Builder of the Year CNBC –  
Awaaz Real Estate Awards 2018

The Golden Peacock National Quality Award  
2017 Institute of Directors 27th World Congress on  
Business Excellence and Innovation

Best Real Estate Brand 2018  
The Economic Times



Stock image is for representative purpose only.



# OUR FOOTPRINT IN MUMBAI

Source: Google Maps. Map not to scale.  
The metro rail and other infrastructure facility(ies) mentioned above are proposed to be developed by the Government and other authorities and we cannot predict the timing or the actual provisioning of these facility(ies), as the same is beyond our control. We shall not be responsible or liable for any delay or non-provisioning of the above. The projects are registered with MahaRERA registration number as below and are available at <http://maharera.mahaonline.gov.in>.  
P51800023915 | P52000001298 | P52000018146 | P51800000165 | P51800000161 | P51800000158 | P51700000120 | P51700024496 | P51700022148 | P51800022159 | P51800000812 | P51700002689 | P51700002442 | P51700013329 | P51700008346 | P51800013802 | P51800001107 | P51800000519 | P51700034608 | P51900034851

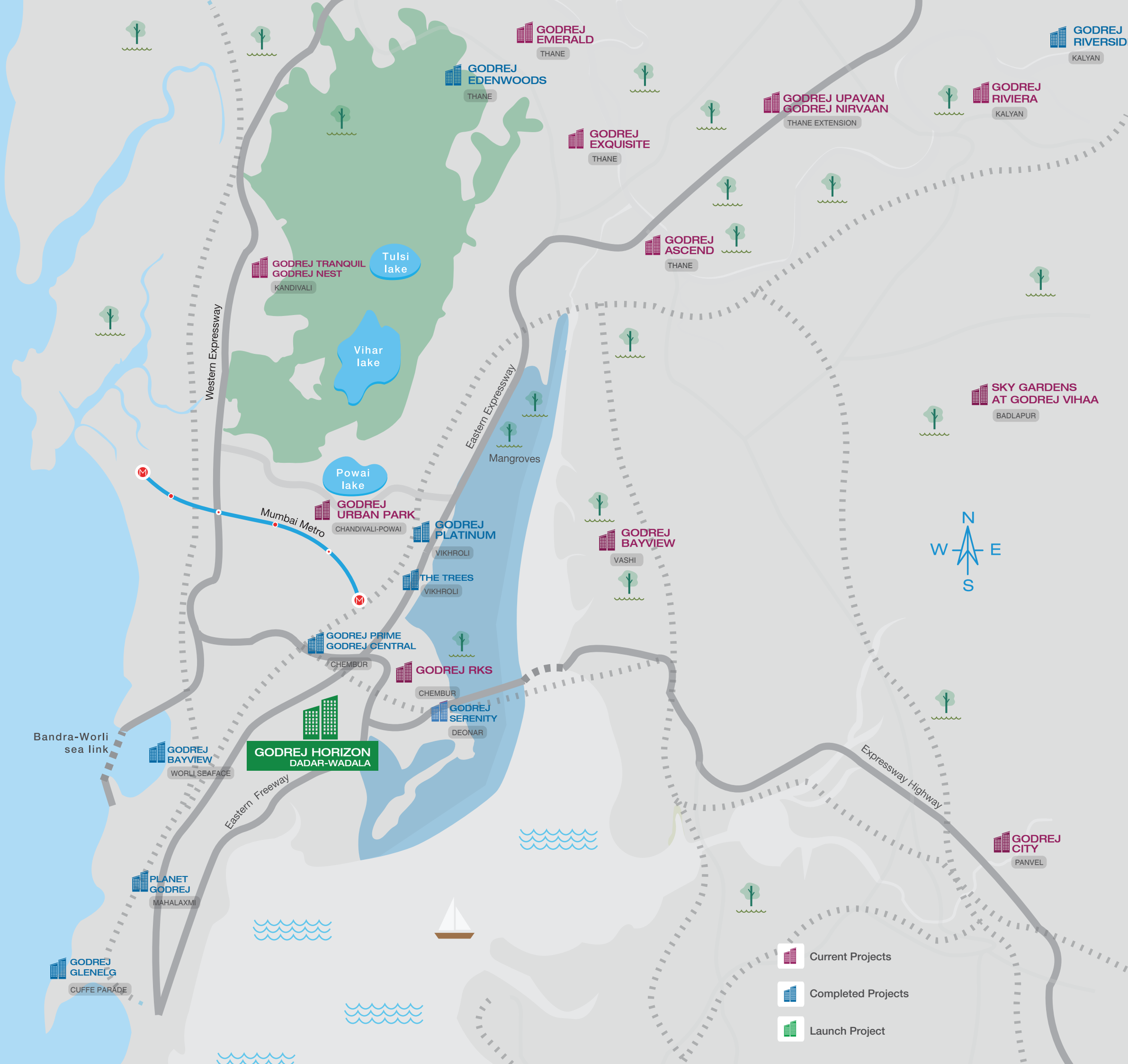

## OUR LANDMARK PROJECTS IN SOUTH BOMBAY



### **GODREJ GLENELG** CUFFE PARADE

A beautiful culmination of conventional and modern architecture



### **GODREJ BAYVIEW** WORLI

A magnificent property with spacious interiors and spectacular sea views



### **PLANET GODREJ** MAHALAXMI

First mega project, overlooking the Mahalakshmi Racecourse







## AND NOW WE ENTER THE HEART OF MUMBAI DADAR-WADALA

### A LOCATION SO GOOD

- 4 min from the Iconic Five Gardens\*
- 4 min from Dadar-TT Circle\*
- Accessibility to best of Social Infrastructure within 9 min\*
- Accessibility to the best of Transit Destinations within 9 min\*



Transite destinations refer to local railway station, monorail station, highways.

Social infrastructure refers to Schools, colleges, hospitals, malls, convenience retail and corporate hubs.

Sources: <https://www.google.com/maps/>

<https://cityseeker.com/mumbai/863072-five-gardens> <https://mumbaioutdoors.com/2013/08/02/five-gardens-matunga-mumbai/> <https://zoroastrians.net/2013/06/24/a-paradise-called-five-gardens-in-mumbai/>

\*This refers to drive time. Drive time refers to the approximate drive duration as provided above and the same is as per Google Maps recorded on 23rd February 2022 at 6 am.



THE GOOD SIDE OF LIFE  
WHERE LEARNING AND DEVELOPEMENT IS

# WITHIN 9 MINUTES\*

## SCHOOLS AND COLLEGES

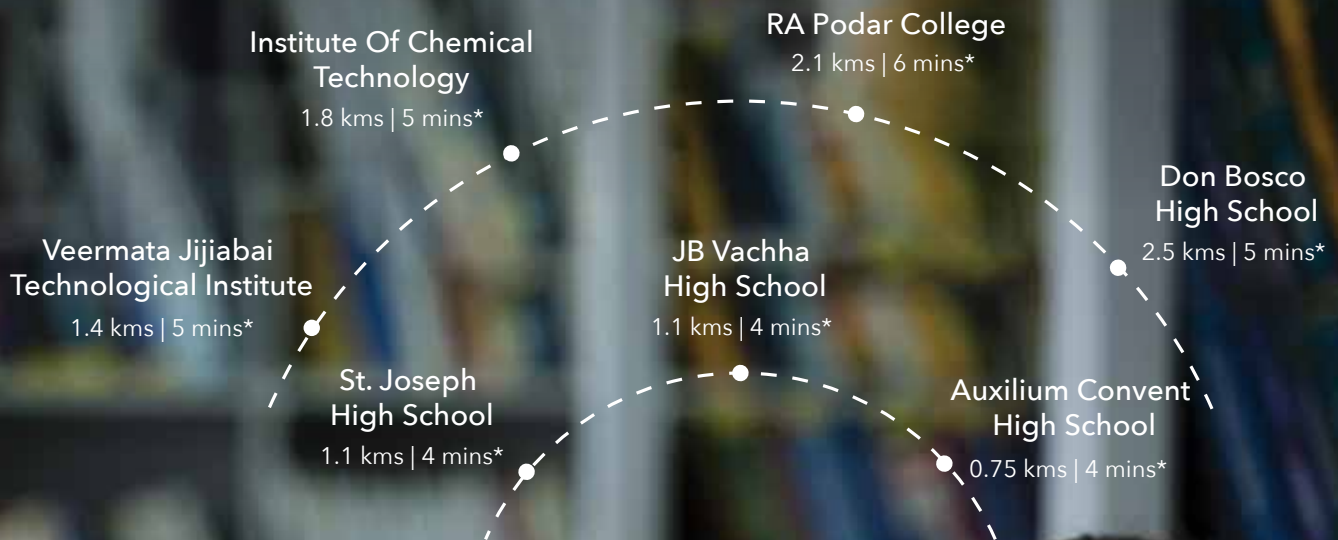

\*This refers to drive time. Drive time refers to the approximate drive duration as provided above and the same is as per Google Maps recorded on 23rd February 2022 at 6 am.

Stock image is for representative purpose only.



THE GOOD SIDE OF LIFE  
WHERE GOOD HEALTH IS

# WITHIN 9 MINUTES\*

## HOSPITALS

TATA Memorial Hospital  
2.6 kms | 8 mins\*

Global Hospital  
2.7 kms | 8 mins\*

King Edward  
Memorial Hospital  
2.4 kms | 7 mins\*



\*This refers to drive time. Drive time refers to the approximate drive duration as provided above and the same is as per Google Maps recorded on 23rd February 2022 at 6 am.

Stock image is for representative purpose only.



THE GOOD SIDE OF LIFE  
WHERE LUSH GREENERY IS

WITHIN 9 MINUTES\*

PARKS AND RECREATION

Dadar Parsi Gymkhana  
1.7 kms | 5 mins\*

Maheshwari Udyan  
2.0 kms | 6 mins\*

Matunga Gymkhana  
2.1 kms | 7 mins\*

Five Gardens  
1.2 kms | 4 mins\*

The Indian Gymkhana  
Matunga  
2.6 km | 8 mins\*



\*This refers to drive time. Drive time refers to the approximate drive duration as provided above and the same is as per Google Maps recorded on 23rd February 2022 at 6 am.

Stock image is for representative purpose only.



THE GOOD SIDE OF LIFE  
WHERE EVERYTHING YOU NEED IS

WITHIN 9 MINUTES\*

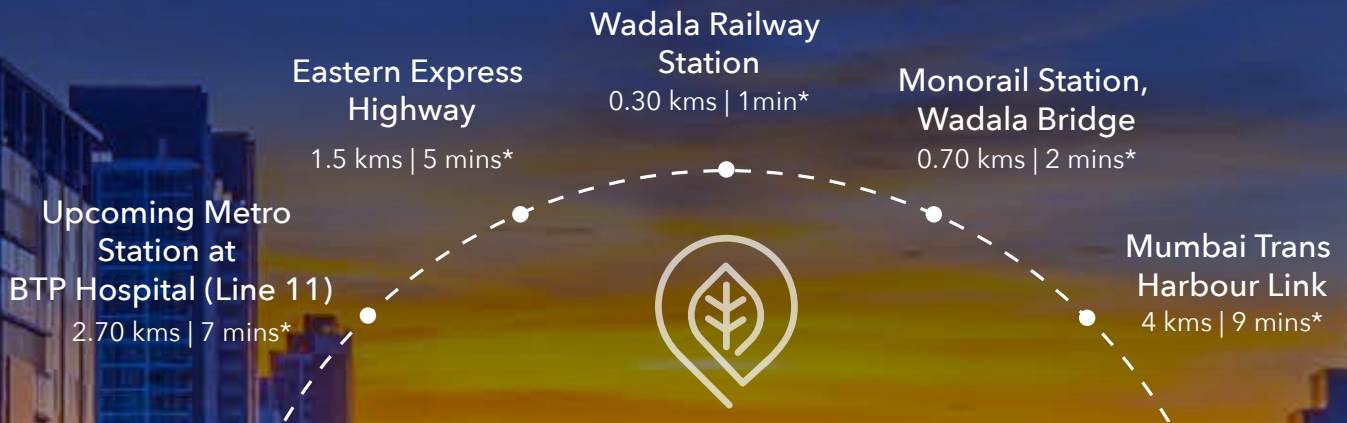

\*This refers to drive time. Drive time refers to the approximate drive duration as provided above and the same is as per Google Maps recorded on 23rd February 2022 at 6 am.

Stock image is for representative purpose only.





## LIFE IS GOOD WHEN YOU'RE WELL-CONNECTED TO EVERY PLACE IN THE CITY

### ROADS

- The BKC-Chunnabhatti Flyover connects Matunga to BKC
- BKC is around 9 kms from the site, which is 18 min of drive-time\*
- Lower Parel can be reached in 10 min through the Eastern Express Highway which is a distance of 5.1 kms\*
- One can reach Powai through Eastern Express Highway in of 30-35 min\*

\*This refers to drive time. Drive time refers to the approximate drive duration as provided above and the same is as per Google Maps recorded on 23rd February 2022 at 6 am.





## MONORAIL CONNECTIVITY

- Wadala monorail station connecting Wadala to Chembur is a 2 min drive from the development\*

## METRO CONNECTIVITY

- Upcoming metro line 4 shall connect Wadala all the way till Kasarvadvali in Thane.

## AIRPORT CONNECTIVITY

- Chatrapati Shivaji International Airport is approximately 12 kms from the development, which takes around 25 min drive-time\*

## MUMBAI TRANS HARBOUR LINK

- Upcoming MTHL, a 6 lane sea bridge connecting Sewri to Navi Mumbai is 16min drive from the development\*



Source: <https://www.metrorailnews.in/cm-devendra-fadnavis-to-flag-off-the-second-phase-of-mumbai-monorail-on-march-2/>

\*This refers to drive time. Drive time refers to the approximate drive duration as provided above and the same is as per Google Maps recorded on 23rd February 2022 at 6 am.

Source: <https://www.mumbai77.com/city/3315/travel/metro-trains/https://mmrda.maharashtra.gov.in/metro-line-4>



# LOCATION MAP



Source: Google Maps. Map not to scale.

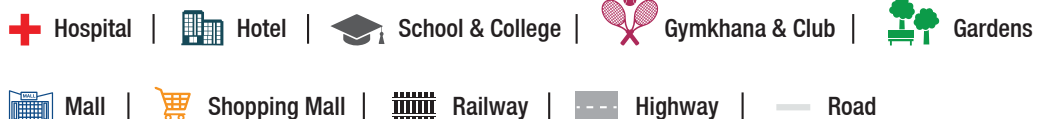





INTRODUCING  
**GODREJ HORIZON**

#TheGoodSideOfLife



# GROUND LEVEL MASTER PLAN

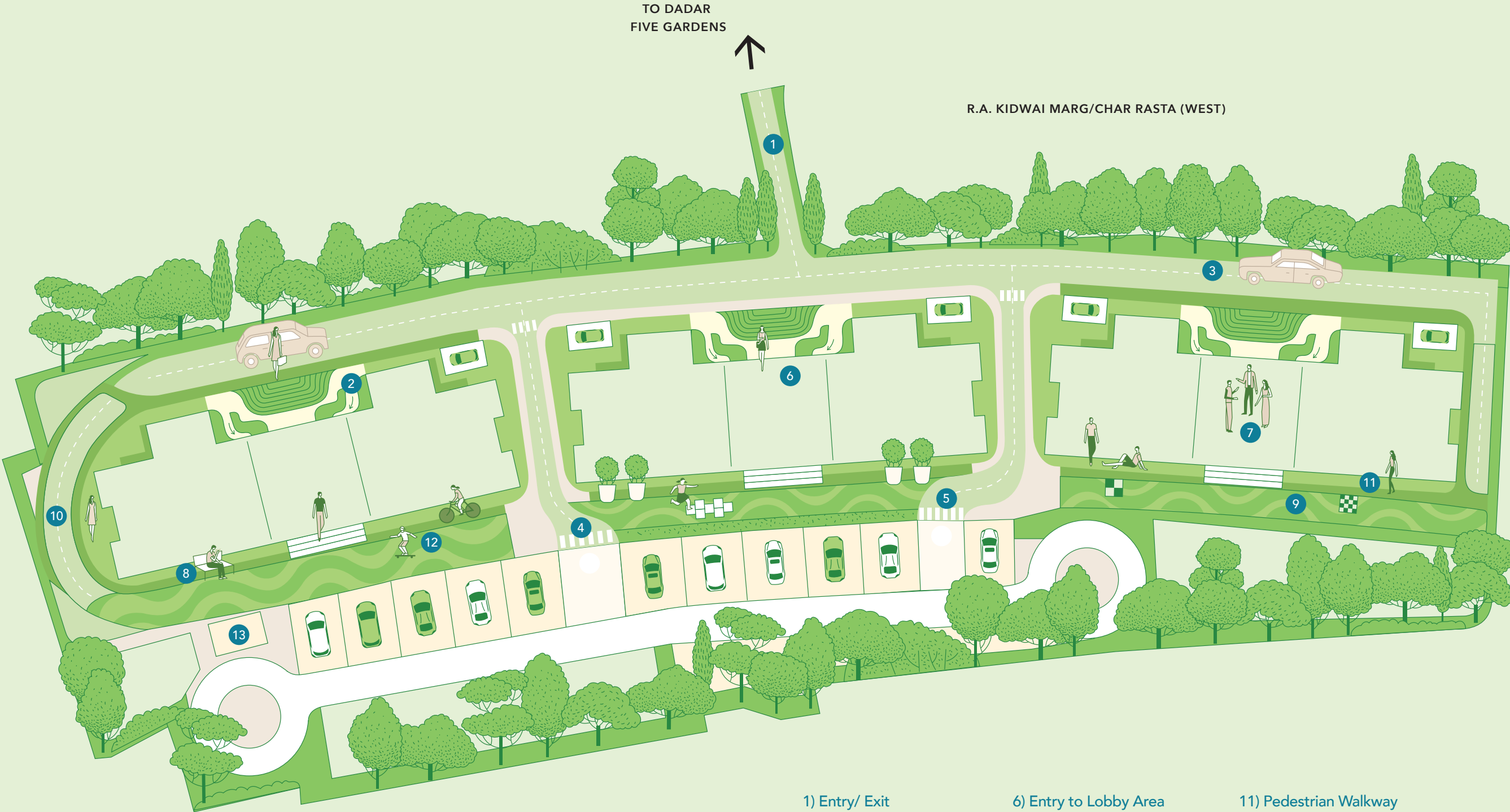

- |                   |                        |                        |
|-------------------|------------------------|------------------------|
| 1) Entry/ Exit    | 6) Entry to Lobby Area | 11) Pedestrian Walkway |
| 2) Ramp Walkway   | 7) Double Height Plaza | 12) Skating Track      |
| 3) Driveway       | 8) Bench Seating       | 13) Car Wash           |
| 4) Exit from MLCP | 9) Active Street       |                        |
| 5) Exit to MLCP   | 10) Emergency Driveway |                        |

The project is registered with MahaRERA registration number as P51900034851 and are available at <http://maharera.mahaonline.gov.in>. The project is being developed by Godrej Projects Development Limited (Developer).  
This contains artist's impressions. No warranty is expressly or impliedly given that the completed development will comply in any degree with such artist's impression as depicted. The furniture, accessories, paintings, plantations, landscaping, items, electronic goods, additional fittings/fixtures, decorative items, false ceiling including finishing materials, specifications, shades, sizes and colour of the tiles, etc. shown in the image are only indicative in nature and are only for the purpose of illustrating/indicating a conceived layout and do not form part of the standard specifications/amenities/services to be provided in the unit and/or the Project.





## PODIUM TOP MASTER PLAN

TO DADAR  
FIVE GARDENS



R.A. KIDWAI MARG/CHAR RASTA (WEST)

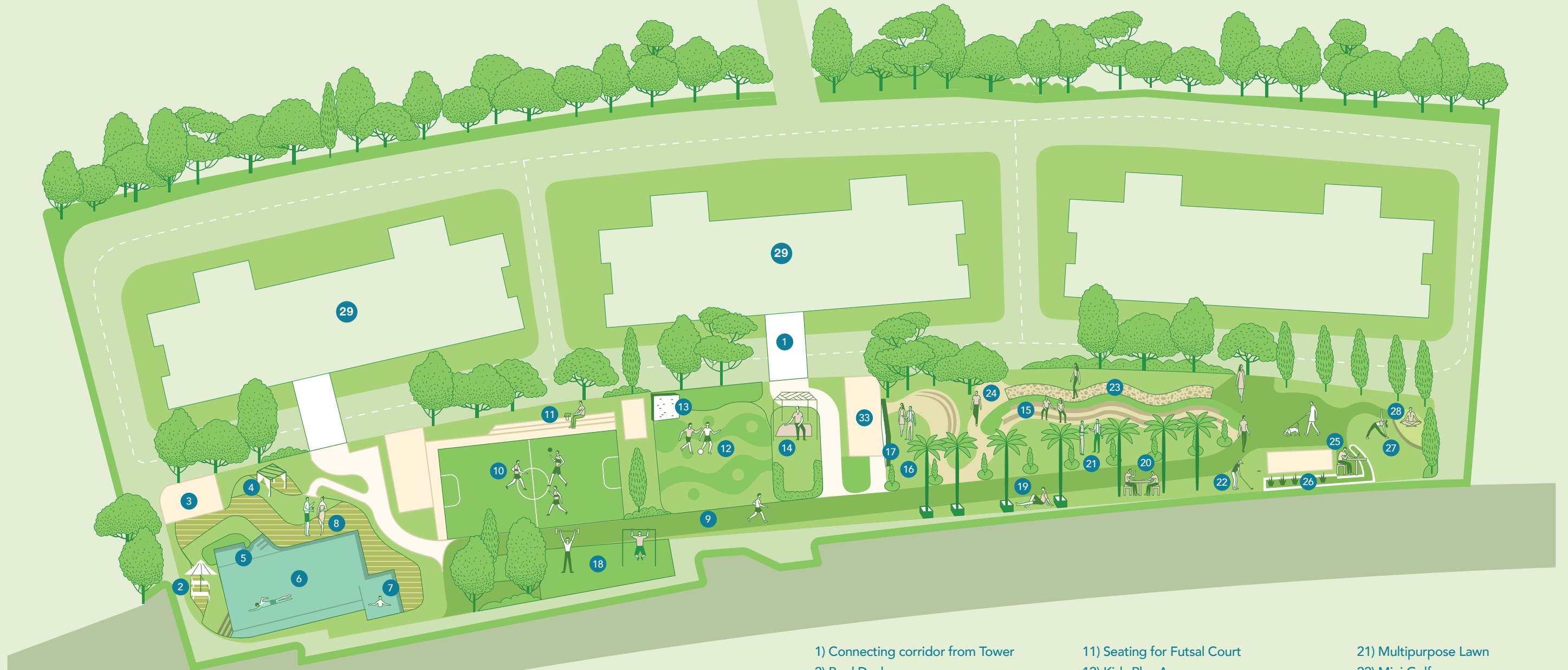

- 1) Connecting corridor from Tower
- 2) Pool Deck
- 3) Changing Room
- 4) Family Pergola
- 5) Jacuzzi
- 6) Semi Olympic pool with Infinity edge
- 7) Kids Pool
- 8) Pool Lounge
- 9) Promenade
- 10) Futsal Court

- 11) Seating for Futsal Court
- 12) Kids Play Area
- 13) Climbing Wall
- 14) Senior Citizens Seating with people
- 15) Amphitheatre seating
- 16) Party area with Screen
- 17) Screen Wall
- 18) Outdoor Gym
- 19) Seating below Palm Tree
- 20) Palm Plaza with Board Games

- 21) Multipurpose Lawn
- 22) Mini Golf
- 23) Reflexology Pathway
- 24) Nature Walk
- 25) Outdoor working stations
- 26) Herb Garden
- 27) Yoga Lawn
- 28) Meditation Deck
- 29) Future Development

The project is registered with MahaRERA registration number as P51900034851 and are available at <http://maharera.mahaonline.gov.in>. The project is being developed by Godrej Projects Development Limited (Developer).

This contains artist's impressions. No warranty is expressly or impliedly given that the completed development will comply in any degree with such artist's impression as depicted. The furniture, accessories, paintings, plantations, landscaping, items, electronic goods, additional fittings/fixtures, decorative items, false ceiling including finishing materials, specifications, shades, sizes and colour of the tiles, etc. shown in the image are only indicative in nature and are only for the purpose of illustrating/indicating a conceived layout and do not form part of the standard specifications/amenities/services to be provided in the unit and/or the Project.



## EXPERIENCE THE GOOD SIDE OF LIFE



**SERENE SUNRISE VIEWS OF THE  
EASTERN BAY**



**STELLAR MUMBAI SKYLINE  
VIEWS**



**MAGNIFICENT 5 STOREYED  
CLUBHOUSE**



**ROOFTOP AMENITIES  
AT THE SKY LOUNGE\***



**SPORTING AMENITIES**



## THE GOOD SIDE OF LIFE

Where the Eastern Bay gives you  
a panoramic welcome



Actual photograph shot at the site





## THE GOOD SIDE OF LIFE

Where the Mumbai Skyline let's you  
take in the magnificence of the city

Actual photograph shot at the site





## **THE GOOD SIDE OF LIFE THAT COMES WITH NEW LEVELS OF FUN.**

Come, discover the 5-storeyed  
Clubhouse, that has lots in store.







## EXPERIENCE THE GOOD SIDE OF LIFE AT THE CLUBHOUSE



**BANQUET HALL**



**FULLY EQUIPPED  
GYMNASIUM**



**LIBRARY**



**CRECHE**



**TECH AND INDOOR  
GAMES ROOM**



**STEAM AND MASSAGE  
ROOM**



## ALL GOOD THINGS, ALL UNDER ONE ROOF, AND ABOVE IT TOO.

Come, indulge in an array of amenities  
at the 0.5 hectares (1.32 acre) sky lounge\*



\*Sky lounge, rooftop refer to MLCP rooftop

Stock image is for representative purpose only.





## EXPERIENCE THE GOOD SIDE OF LIFE AT THE OPEN AIR ROOFTOP



**KIDS' POOL**



**OUTDOOR WORK STATIONS**



**KIDS' PLAY AREA**



**AMPHITHEATRE**



**MINI GOLF**



**YOGA DECKS**



## THE GOOD SIDE OF LIFE THAT'LL MOTIVATE YOU TO BE A SPORT

Experience adrenaline rush and  
enjoy an array of sporting amenities







## EXPERIENCE THE GOOD SIDE OF LIFE WITH AN ARRAY OF SPORTING AMENITIES



**JOGGING TRACK**



**HALF-OLYMPIC  
SWIMMING POOL**



**FUTSAL COURT**



**2 SQUASH COURTS**



**2 DOUBLE HEIGHTED  
BADMINTON COURTS**



---

**Site Address: Godrej Horizon Phase I, R. A. Kidwai Road, Azad Nagar, Wadala (West), Mumbai - 400 031**

The project is registered with MahaRERA registration number as P51900034851 and are available at <http://maharera.mahaonline.gov.in>. The project is being developed by Godrej Projects Development Limited (Developer).

The Sale is subject to terms of Application Form and Agreement for Sale. All specifications of the unit shall be as per the Agreement for Sale. Customers are advised to apprise themselves of the necessary and relevant information of the project prior to making any purchase decisions. The official website of Godrej Properties Limited is [www.godrejproperties.com](http://www.godrejproperties.com). Please do not rely on the information provided on any other website. The Developer shall not be liable for any information that may be circulated by any third party about the project. Further, the Developer shall not be liable for any transaction entered into, with any third party basis the information that may be circulated by such third party about the project. Developer reserves the right to develop/launch future development/future phases, as the Developer deems fit and proper. T and C apply.